

THIS DRAWING IS THE PROPERTY OF PRIMARY FLUID SYSTEMS INC. FROM WHICH A WRITTEN CONSENT FOR APPROVAL SHALL BE REQUIRED PRIOR TO COPYING.

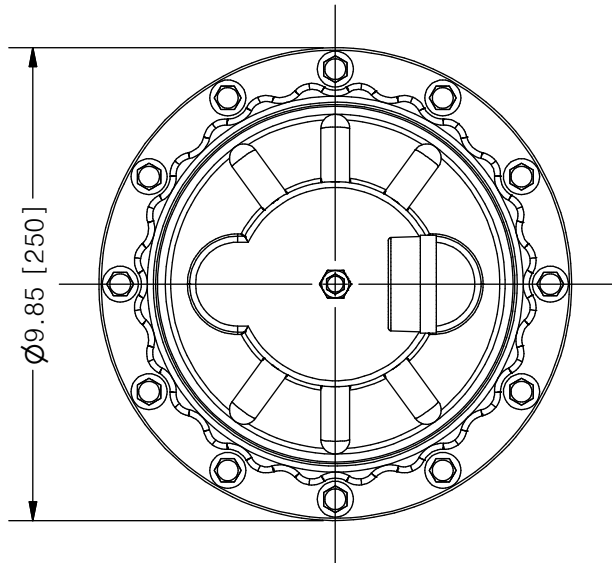

ACCU-PULSE®
APIIIF PULSATION DAMPENER

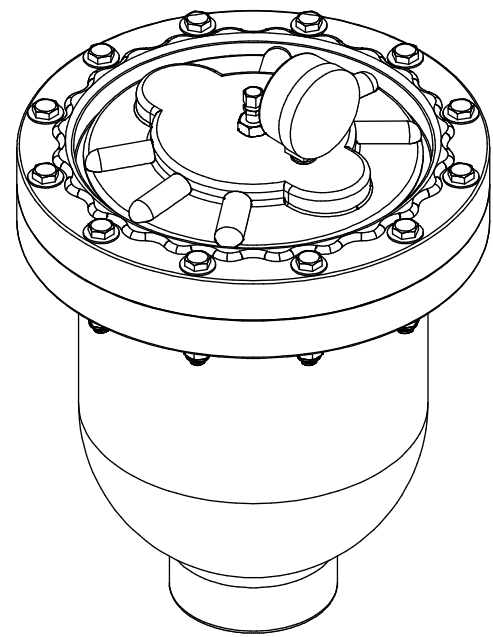

SCALE 1 : 4

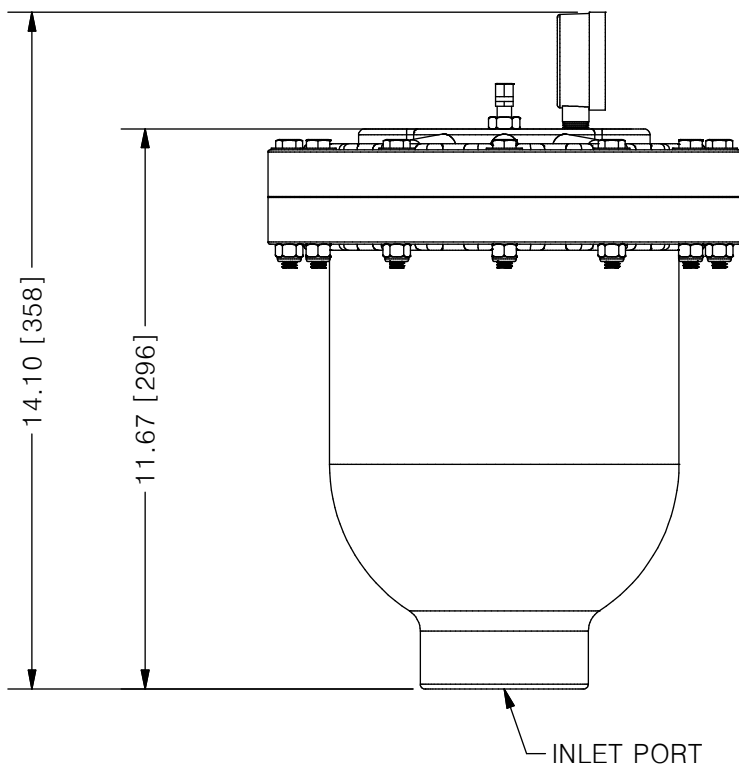

AVAILABLE BLADDER/BELLOW
EPDM
VITON
NEOPRENE
BUNA-N
HYPALON
PTFE

NO.	NAME	DESCRIPTION
1	MAX ALLOWABLE OPERATING PRESSURE	150PSI @ 70°F (21°C)
2	UNIT CAPACITY	175 CU IN
3	INLET PORT	2"
4	CONNECTION TYPE	NPT
5	BOTTOM HOUSING (WETTED)	PVC/PP/PVDF
6	BLADDER (WETTED)	SEE CHART ABOVE
7	TOP HOUSING	GF NORYL
8	GAUGE CASE/BACKING	PLASTIC AND BRASS
9	FILL VALVE	STAINLESS STEEL
10	FASTENER ASSEMBLY RING/BOLTS	NORYL AND STAINLESS STEEL

PRIMARY FLUID SYSTEMS INC. 1050 COOKE BLVD, BURLINGTON, ONTARIO L7T 4A8	PROJECT: AP	SHT: 1 OF 1	DRAWN BY: NIKHIL G
	DATE DRAWN: 8/15/2016	SCALE: 1 : 4	UNITS: INCH[mm]
TITLE: ACCU-PULSE IIIIF PULSATION DAMPENER	MATERIAL: SEE CHART	DWG NO.: APIIIF-POLY_RI	REVISION: 1
DWG NAME: APIIIF	APPROVED BY:	CHECKED BY:	DIMENSIONAL TOLERANCE 0.XX ± 0.25"
DWG TYPE: PLANAR VIEW 2D			

11 X 17 SHEET SIZE: **B**