

THIS DRAWING IS THE PROPERTY OF PRIMARY FLUID SYSTEMS INC. FROM WHICH A WRITTEN CONSENT FOR APPROVAL SHALL BE REQUIRED PRIOR TO COPYING.

|                     | NO. | NAME  | DESCRIPTION                   |
|---------------------|-----|---|-------------------------------|
|                     | 1   | MAX ALLOWABLE OPERATING TEMPERATURE             | 140°F (60°C)                  |
|                     | 2   | MAX ALLOWABLE OPERATING PRESSURE                | 15 PSIG                       |
|                     | 3   | LEAK TEST                                       | YES                           |
| CONNECTIONS         | 4   | BOTTOM PORT CONNECTION                          | 2"                            |
|                     | 5   | TOP PORT CONNECTION                             | 2"                            |
|                     | 6   | TYPE  | NPT                           |
| MATERIALS           | 7   | CYLINDER  | GLASS                         |
|                     | 8   | END CAPS  | SS316L (OPTION ALLOY20, C276) |
|                     | 9   | GLASS SEALING 'O' RINGS                         | VITON (OPTION EPDM, PTFE)     |
| MATERIAL NON WETTED | 10  | OUTER SHIELD                                    | POLYCARBONATE                 |
|                     | 11  | SHIELD SEALING 'O' RINGS                        | BUNA-N                        |
| INPUT DATA          | 12  | VOLUME SIZE                                     | 20000 ML                      |
| SCALE               | 13  | GRADUATION                                      | 200 ML                        |
| COMMENTS            | 14  | ALL CYLINDERS ARE RATED FOR LIQUID SERVICE ONLY |                               |
|                     | 15  | CYLINDERS ARE NOT PRESSURE VESSELS              |                               |

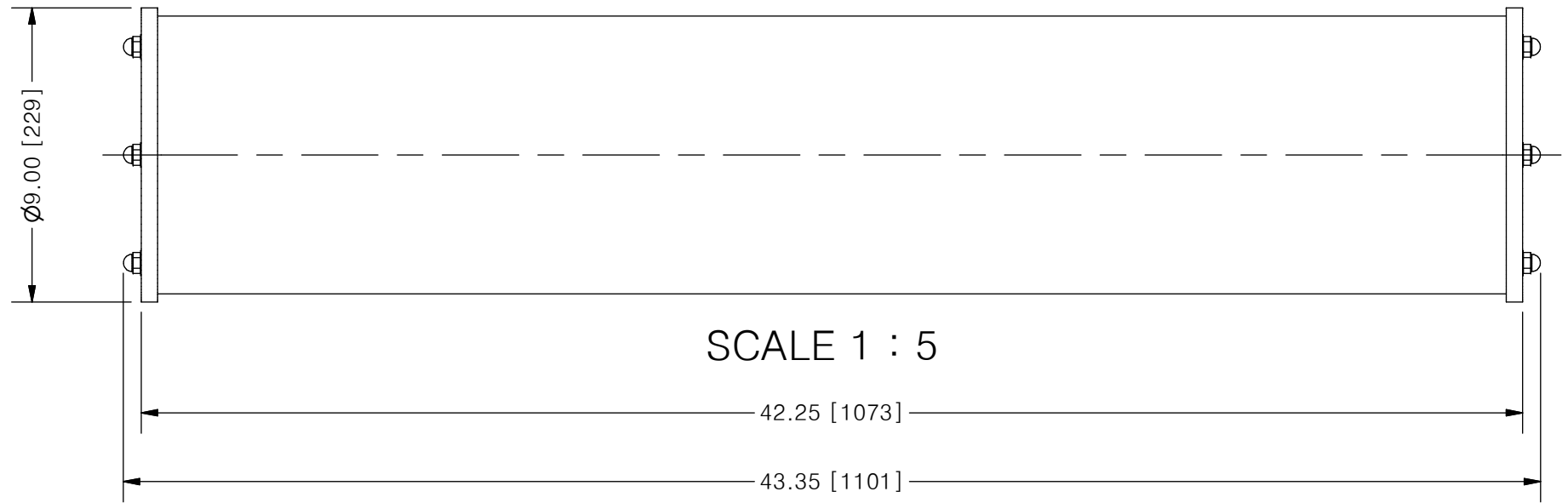
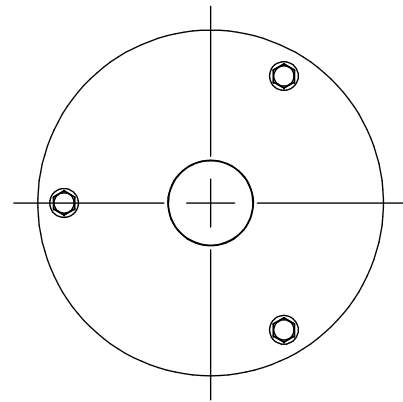
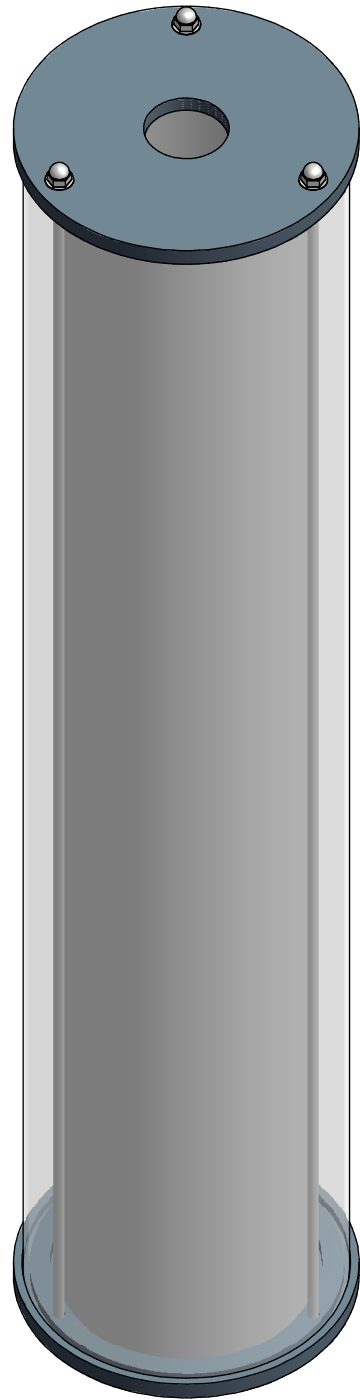

## ACCUDRAW® ACS#2 GLASS CALIBRATION CYLINDER

| REV | DESCRIPTION   | DATE      | NAME |
|-----|---|-----------|------|
| 1   | END CAP MAT'L SS316L WAS SS316; MAT'L OPTIONS ADDED | 6/24/2021 | FS   |

REVISION HISTORY

|   |  |                       |              |   |
|---|--|-----------------------|--------------|---|
| <b>PRIMARY FLUID SYSTEMS INC.</b><br>1050 COOKE BLVD, BURLINGTON, ONTARIO L7T 4A8 |  | PROJECT: ACS          | SHT: 1 OF 1  | DRAWN BY: NG  |
| TITLE: 20000 ML CALIBRATION CYLINDER WITH 2" NPT CONNECTION                       |  | DATE DRAWN: 8/19/2016 | SCALE: 1 : 5 | UNITS: INCH [mm]  |
| DWG NO: ACS#2-20000-GSV_R1  |  | MATERIAL: SEE CHART   | REV# 1       |   |
| DWG NAME: ACS CYLINDER<br>DWG TYPE: PLANAR VIEW                                   |  | APPROVED BY:          | CHECKED BY:  | DIMENSIONAL TOLERANCE<br>0.X = ± 0.25"<br>0.XX = ± 0.25"<br>0.XXX = ± 0.25" |

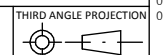

B